



EPT20-15ET2

ELECTRIC PALLET TRUCK 1.5T

1500 kg 115 mm 24 V Li-Ion



The EPT20-15ET2 is ideal for indoor environments such as retail stores, small warehouses, and light logistics applications. Its compact design and low service weight (180 kg) enable easy maneuvering in tight spaces. The truck also offers optional attachments including a cargo backrest, storage box, or built-in electric scale, adapting to various operational needs.

SPECIFICATION	REF	UNIT	VALUE
Battery type			Li-Ion
Battery nominal capacity K5		Ah	72
Battery voltage		V	24
Rated capacity	Q	kg	1500
Load centre distance	c	mm	600
Service weight		kg	165 (173)
Lift	h ₃	mm	115
Overall length		mm	1638
Overall width	b ₁ /b ₂	mm	560 (685)
Length to face of forks	l ₂	mm	488
Fork dimensions	s/e/l	mm	50X150X1150
Turning radius		Wa	1475
Manufacturer			EP
Model designation			EPT20-15ET2
Drive			Electric
Operator type			Pedestrian

Features

Compact & lightweight

With a 1.5-ton capacity and a compact frame, the EPT20-15ET2 offers excellent maneuverability. Its 180 kg service weight makes it easy to operate in tight aisles and small warehouses.

Easy maintenance

A front detachable battery cover and optimized harness layout allow quick access for battery replacement and servicing. This design reduces downtime and ensures reliable long-term performance.

Enhanced safety

Equipped with an upgraded emergency switch and a strong driving wheel cover, the truck improves operator safety during daily operations.

Flexible attachments

The EPT20-15ET2 supports optional add-ons such as an electric scale, cargo backrest, or storage box, allowing customization to meet different application needs.

VDI Chart

	SPECIFICATION	REF	UNIT	VALUE
1.1	Manufacturer			EP
1.2	Model designation			EPT20-15ET2
1.3	Drive			Electric
1.4	Operator type			Pedestrian
1.5	Rated capacity	Q	kg	1500
1.6	Load centre distance	c	mm	600
1.8	Load distance, centre of drive axle to fork		mm	946
1.9	Wheelbase		mm	1261
2.1	Service weight		kg	165 (173)
2.2	Axle loading, laden front/rear		kg	567/1128
2.3	Axle loading, unladen front/rear		kg	155/40

SPECIFICATION		REF	UNIT	VALUE
3.1	Tyres			Polyurethane
3.2	Tyre size, front		mm	Φ210x70
3.3	Tyre size, rear		mm	Φ80x61
3.5	Wheels, number front/rear (x=drive wheels)			1x , —/4
3.6	Tread width, front	b ₁₀	mm	-
3.7	Tread width, rear	b ₁₁	mm	410 (535)
4.4	Lift	h ₃	mm	115
4.9	Height drawbar in driving position min./max.			750/1170
4.15	Height, lowered			80
4.19	Overall length		mm	1638
4.20	Length to face of forks	l ₂	mm	488
4.21	Overall width	b ₁ /b ₂	mm	560 (685)
4.22	Fork dimensions	s/e/l	mm	50X150X1150
4.25	Distance between fork-arms			560 (685)
4.32	Ground clearance, centre of wheelbase		mm	30
4.34.1	Aisle width for pallets 1000×1200 crossways		Ast	2280
4.34.2	Aisle width for pallets 800 × 1200 crossways		Ast	2150
4.35	Turning radius		Wa	1475
5.1	Travel speed, laden/unladen		km/h	4.5/5
5.2	Lift speed, laden/unladen		m/s	0.027/0.038
5.3	Lowering speed, laden/unladen		m/s	0.059/0.039
5.8	Max. gradeability, laden/unladen		%	5/16
5.10	Service brake			Electromagnetic
6.1	Drive motor rating S2 60 min		kW	0.75
6.2	Lift motor rating at S3 15%		kW	0.8
6.4	Battery nominal capacity K5		Ah	72
6.4	Battery voltage		V	24
6.4.1	Battery type			Li-Ion
6.5	Battery weight		kg	34
8.1	Type of drive unit			DC
10.5	Steering design			Mechanical
10.7	Sound pressure level at the driver's seat		dB(A)	74

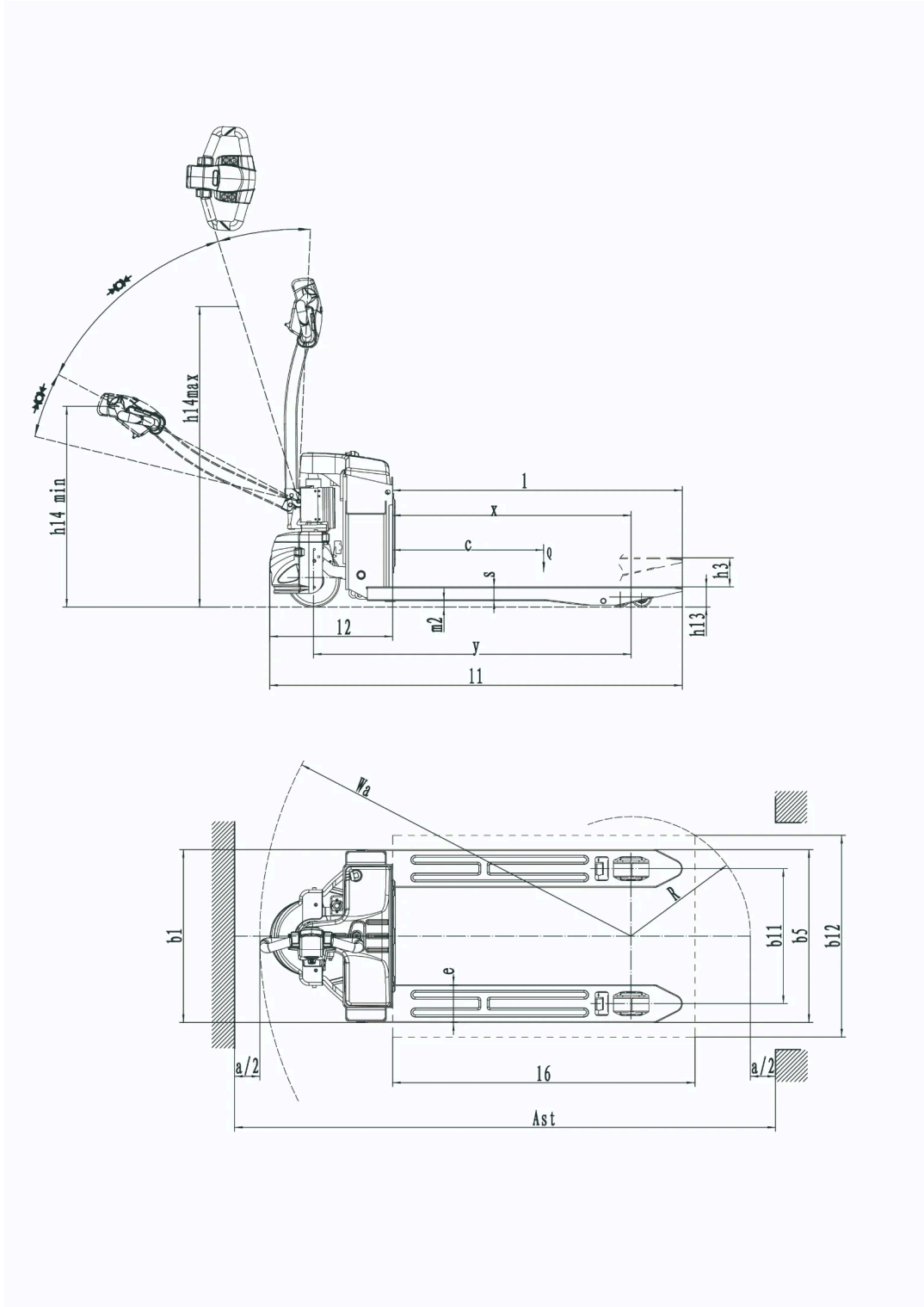

Options

ITEM	OPTIONS (optional items marked in yellow)
Fork lowered height	80 60

ITEM	OPTIONS (optional items marked in yellow)
Load wheel type	Double Single
Load wheel material	PU
Drive wheel material	PU
Battery capacity	65Ah 85Ah
Charger	24V-10A internal
Battery display indicator (BDI)	With time
Castor wheels	No Yes and not customized
Fork length	1150 800-2000
Fork width	560 685 520 460 420 600